





[www.worky-italy.com](http://www.worky-italy.com)

ACCESSORIES

**WORKY®**



# GON

The GON (Gas Oval Nozzle) rubber nozzle has a suction intake of 4.13" x 8.26" and was developed by WORKY to follow the development of the exhaust mufflers of sports cars.

The product has been optimized for coupled exhausts, coupled exhausts on both sides of the vehicle and exhaust mufflers fully integrated into the rear bumper.

All clamp versions are available on both the left side of the cone (standard version) and on the right side. Thanks to this flexibility, it is very easy to fix the GON on cars with double exhaust mufflers



## GON-EG - technical datasheet

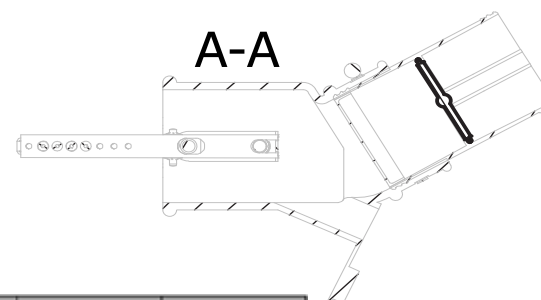
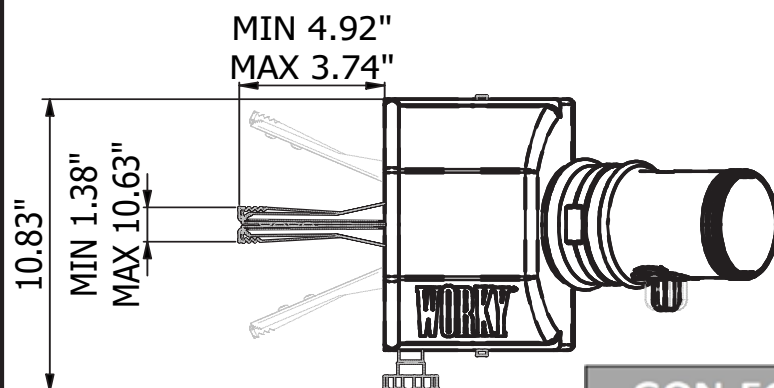
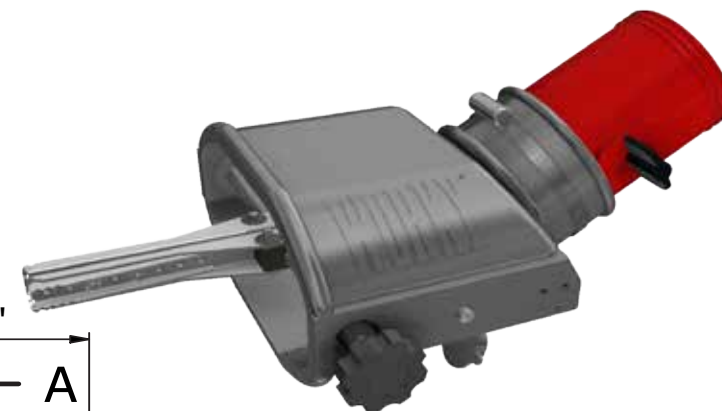
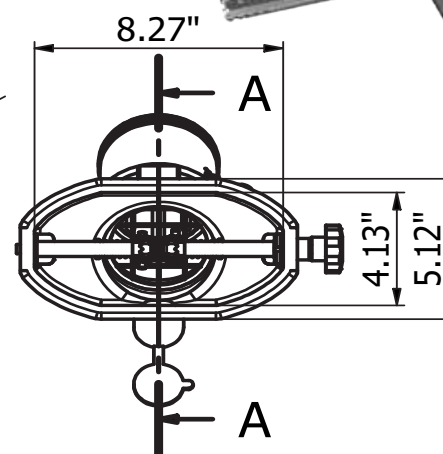
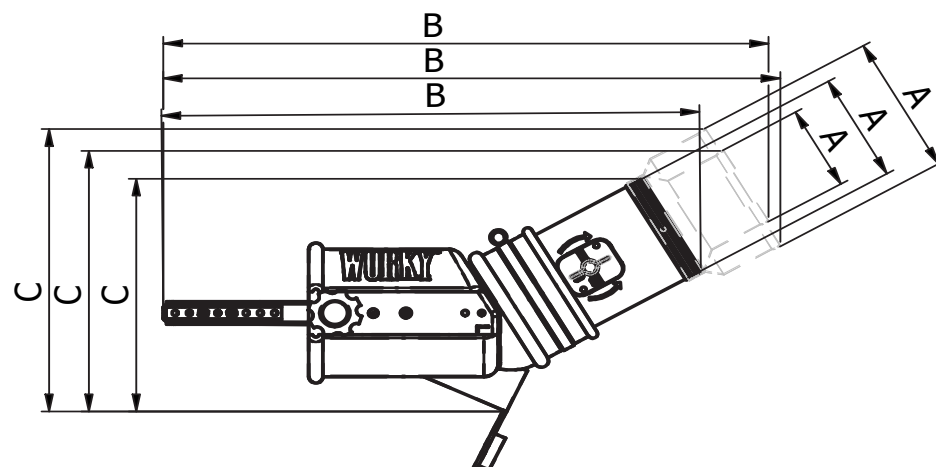

GON-EG	A Ø	B	C
GON-75EG	3"	20"	9.65"
GON-100EG	4"	17.90"	8.46"
GON-125EG	5"	20.47"	10.43"

 " x " x H  
 lb 5.5

THIS DRAWING IS PROPERTY OF RO & Co S.p.A. THE COMPLETE OR PARTIAL REPRODUCTION OF THIS DOCUMENT IS FORBIDDEN. THE OWNER RESERVES THE RIGHT TO UPDATE, MODIFY OR AMEND ANY SPECIFICATION WITHOUT PRIOR NOTICE.

Rev.00

11/06/2021



# GON



Oval rubber nozzle with 4.13" x 8.26" suction opening and 30° hose coupling with fully tight manual closing valve, probe for C.O. test.

GON	Ø Hose	Suction Intake
GON-75	3"	4.13" x 8.26"
GON-100	4"	4.13" x 8.26"
GON-125	5"	4.13" x 8.26"

# GON-K



Oval rubber nozzle with 4.13" x 8.26" suction opening and 30° hose coupling with fully tight manual closing valve, probe for C.O. test and fixing clip with vulcanized rubber end.

GON-K	Ø Hose	Clip position	Suction Intake
GON-75K	3"	left	4.13" x 8.26"
GON-75KR	3"	right	4.13" x 8.26"
GON-100K	4"	left	4.13" x 8.26"
GON-100KR	4"	right	4.13" x 8.26"
GON-125K	5"	left	4.13" x 8.26"
GON-125KR	5"	right	4.13" x 8.26"



# GON-MG



Oval rubber nozzle with 4.13" x 8.26" suction opening and 30° hose coupling with fully tight manual closing valve, probe for C.O. test and fixing gripper with vulcanized rubber ends.

GON-MG	Ø Hose	GRIP position	Suction Intake
GON-75MG	3"	left	4.13" x 8.26"
GON-75MGR	3"	right	4.13" x 8.26"
GON-100MG	4"	left	4.13" x 8.26"
GON-100MGR	4"	right	4.13" x 8.26"
GON-125MG	5"	left	4.13" x 8.26"
GON-125MGR	5"	right	4.13" x 8.26"

# GON-EG



Oval rubber nozzle with 4.13" x 8.26" suction opening and 30° hose coupling with fully tight manual closing valve, probe for C.O. test and internal expanding grip with adjustable beaks.

GON-EG	Ø Hose	knob position	Suction Intake
GON-75EG	3"	left	4.13" x 8.26"
GON-75EGR	3"	right	4.13" x 8.26"
GON-100EG	4"	left	4.13" x 8.26"
GON-100EGR	4"	right	4.13" x 8.26"
GON-125EG	5"	left	4.13" x 8.26"
GON-125EGR	5"	right	4.13" x 8.26"

# GV-100



Plastic cowling reinforced with fiberglass diam 4" resistant up to 400°F equipped with air tight butterfly valve and safety net.

007.12.016.0



30° bent rubber swivel for nozzles GRN and GON

# GRN

The GRN (Gas Rubber Nozzle) rubber nozzle has a suction intake of 6.3" diameter and was developed by WORKY to adapt to the many conformations of the most common exhaust pipes on the market. The product is designed to be configured with fixing clips, grip clamp, membrane cap, grabbing handle and 30° bend as optionals.

All versions have opacimeter probe opening Ø 1.25" and a coupling with airtight sealing valve complete with protection net against foreign bodies.



A brand of RO & Co S.p.A.  
(U.S. BRANCH)  
601 Brickell Key Drive  
Miami, Florida 33131, USA  
Tel. +1 305 (705) 5017  
sales@worky-america.com

www.worky-italy.com

GRNG - technical datasheet

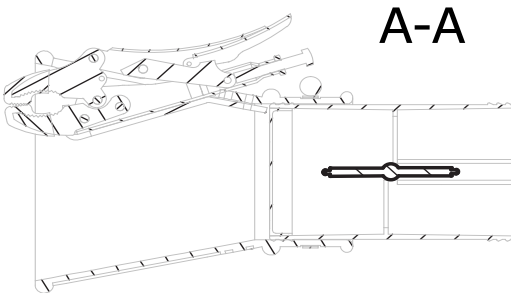
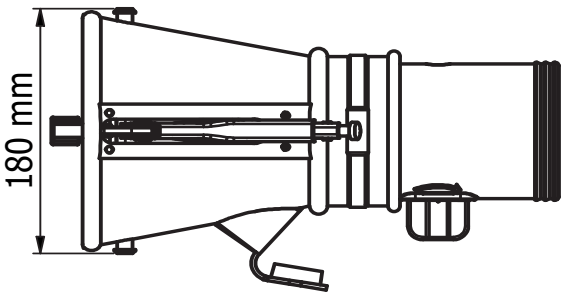
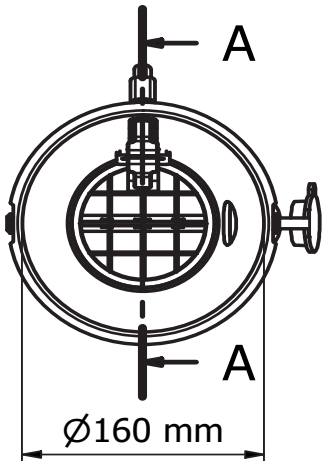
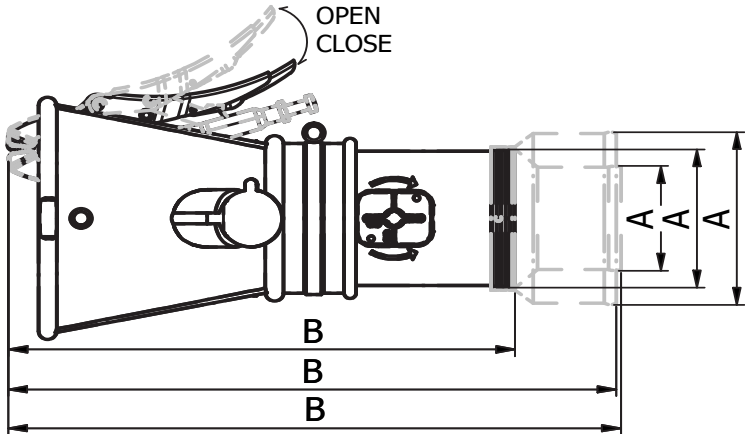

GRNG	A Ø	B
GRNG-16075	3"	15.94"
GRNG-160100	4"	13.19"
GRNG-160125	5"	15.82"

" x x H  
lb 3,31

THIS DRAWING IS PROPERTY OF RO & Co S.p.A. THE COMPLETE OR PARTIAL REPRODUCTION OF THIS DOCUMENT IS FORBIDDEN. THE OWNER RESERVES THE RIGHT TO UPDATE, MODIFY OR AMEND ANY SPECIFICATION WITHOUT PRIOR NOTICE.

Rev.00

16/06/2021



# GRN



Rubber nozzle with 6.3" suction diameter, hose coupling with fully tight manual closing valve and probe intake for C.O. test.

GRN	Ø Hose	Ø Suction
GRN-16075	3"	6.3"
GRN-160100	4"	6.3"
GRN-160125	5"	6.3"

# GRNT



Rubber nozzle with 6.3" suction diameter, rubber closing membrane, hose coupling with fully tight manual closing valve and probe intake for C.O. test.

GRNT	Ø Hose	Ø Suction
GRNT-16075	3"	6.3"
GRNT-160100	4"	6.3"
GRNT-160125	5"	6.3"

# GRNK



Rubber nozzle with 6.3" suction diameter, fixing clip with vulcanized rubber end, hose coupling with fully tight closing valve and probe intake for C.O. test.

GRNK	Ø Hose	Ø Suction
GRNK-16075	3"	6.3"
GRNK-160100	4"	6.3"
GRNK-160125	5"	6.3"

# GRNG



Rubber nozzle with 6.3" suction diameter, grip clamp with vulcanized rubber ends, hose coupling with fully tight closing valve and probe intake for C.O. test.

GRNG	Ø Hose	Ø Suction
GRNG-16075	3"	6.3"
GRNG-160100	4"	6.3"
GRNG-160125	5"	6.3"

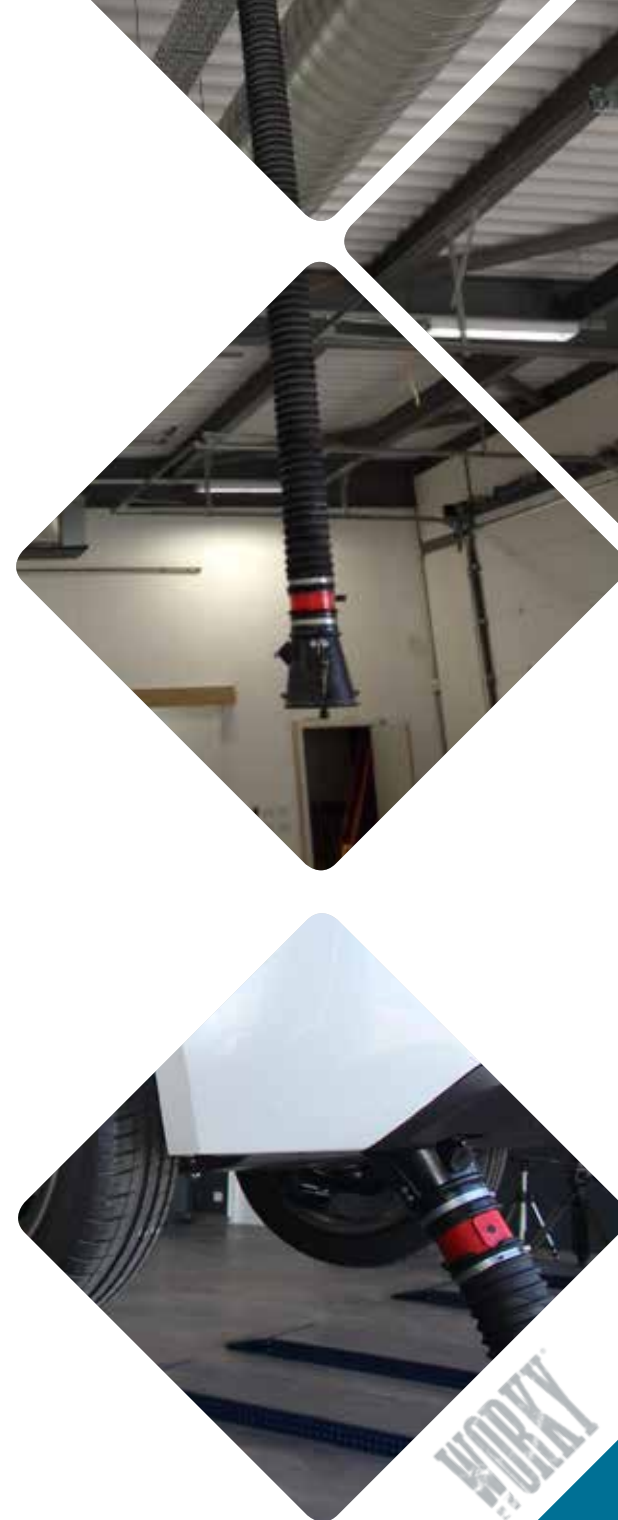

## 007.12.015.0



Membrane cap for nozzle mod. GRNT

007.12.015.0	GRN	GON
007.12.015.0	√	-

## 007.12.016.0



30° bent rubber swivel for nozzles GRN and GON

007.12.016.0	GRN	GON
007.12.016.0	√	√

## 007.12.017.0



Rubber handle for GRN Nozzles

007.12.017.0	GRN	GON
007.12.017.0	√	-

## GV-100



Heavy duty plastic cowling glass reinforced diam. 4" resistant up to 400°F equipped with butterfly valve and safety net.

GV-100	GRN	GON
GV-100	√	√





# GYNMA

The GYNMA double nozzles mounted on the trolley offer a universal and contactless solution for every car. The fact that it is mounted on a trolley allows an easy handling and the multi-regulation offered by the adjustable armlets provides a unique flexibility of its kind. GYNMA offers several configurations, diameters and temperature resistance. Now extracting the exhaust gas from double silencer's cars will no longer be a problem, GYNMA fits to any vehicle and can get connected to existing single pipe systems. The ergonomic trolley and friendly application make GYNMA the universal nozzle for all cars or motorbikes.



A brand of RO & Co S.p.A.  
(U.S. BRANCH)  
601 Brickell Key Drive  
Miami, Florida 33131, USA  
Tel. +1 305 (705) 5017  
sales@worky-america.com

www.worky-italy.com

## GYNMAG-GON100 - technical datasheet

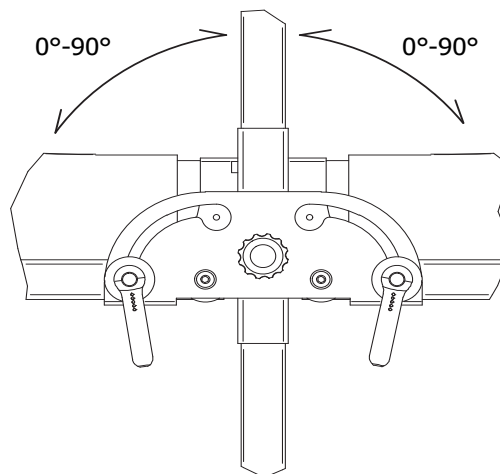
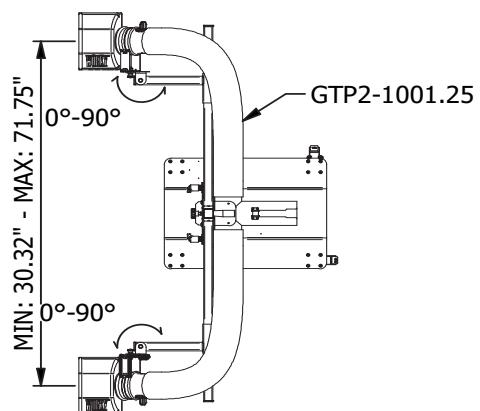
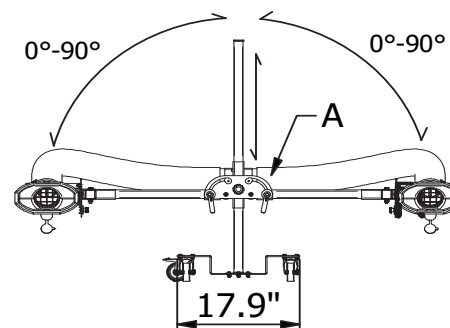
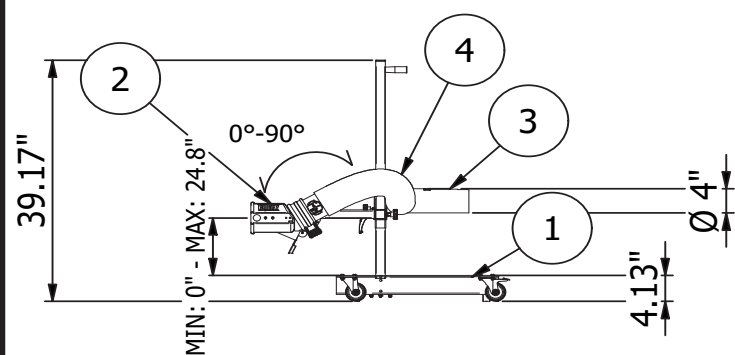

POS.	QNT	CODE
1	1	GYNMA-WN
2	2	GON-100
3	1	607.12.012.0 + 700.16.003.2
4	2	GTP2-1001.25



" x x H  
lb 59,5

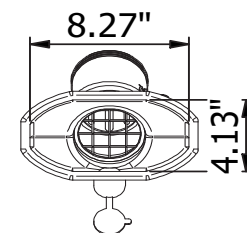
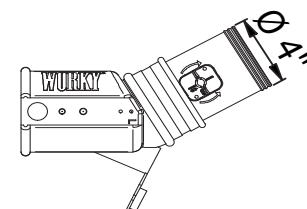

THIS DRAWING IS PROPERTY OF RO & Co S.p.A. THE COMPLETE OR PARTIAL REPRODUCTION OF THIS DOCUMENT IS FORBIDDEN. THE OWNER RESERVES THE RIGHT TO UPDATE, MODIFY OR AMEND ANY SPECIFICATION WITHOUT PRIOR NOTICE.

Rev.00

14/06/2021



# GYNMA-WN



Trolley mounted metal structure with adjustable arms and collars for supporting a custom made double nozzle set.

GYNMA-WN	H max	L max
GYNMA-WN	3'	6'
GYNMA2-WN	7'	6'

# GYNMAG

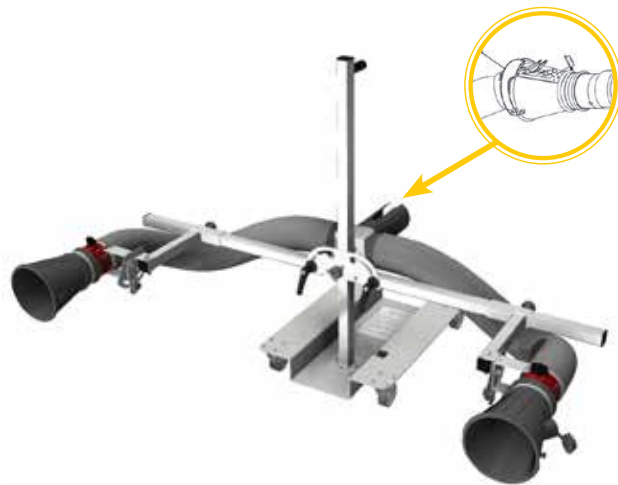

Trolley mounted nozzle for double exhaust pipes, complete with Y piece suitable for a quick connection to the GRNG nozzle, two hoses 5' long each, clamps and two rubber nozzles model GRN mounted on independently adjustable armlets.

GYNMAG	Ø A	Ø B	Ø C	Nozzle
GYNMAG-1007575	4"	3"	3"	GRN-16075
GYNMAG-100100100	4"	4"	4"	GRN-160100

# GYNMAG-GON

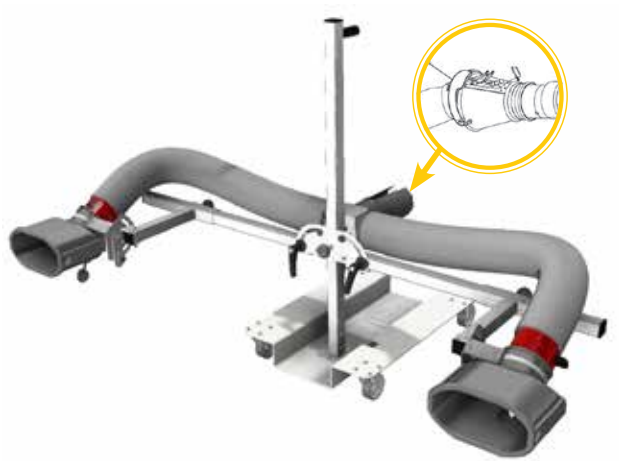

Trolley mounted nozzle for double exhaust pipes, complete with Y piece suitable for a quick connection to the GRNG nozzle, two hoses 5' long each, clamps and two oval nozzles model GON mounted on independently adjustable armlets.

GYNMAG-GON	Ø A	Ø B	Ø C	Nozzle
GYNMAG-GON75	4"	3"	3"	GON-75
GYNMAG-GON100	4"	4"	4"	GON-100









# GYNMA-HT5

950°F



Trolley mounted nozzle for double exhaust pipes, two high temperature resistant hoses 4' long each, clamps and two stainless steel nozzles mounted on independently adjustable armlets.

GYNMA-HT	Ø A	Ø B	Ø C	Lungh. / Lenght
GYNMA-150125125HT5	6"	5"	5"	2 x 4' - 950°F

# GYNMA-HT7

1300°F



Trolley mounted nozzle for double exhaust pipes, two very high temperature resistant hoses 4' long each, clamps and two stainless steel nozzles mounted on independently adjustable armlets.

GYNMA-HT	Ø A	Ø B	Ø C	Hose lenght
GYNMA-150125125HT7	6"	5"	5"	2 x 4' - 1300°F

# GYNMA-DPFHT7

1300°F

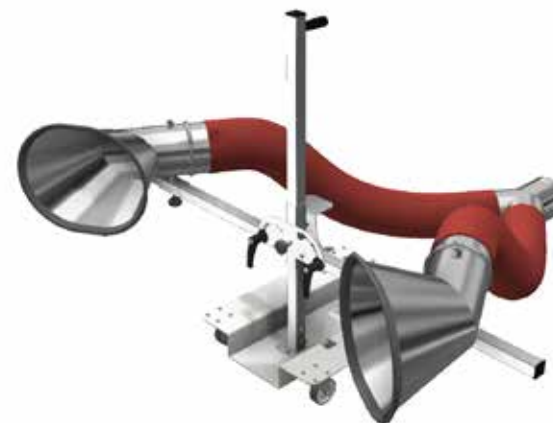

Trolley mounted nozzle for double exhaust pipes, two very high temperature resistant hoses 4' long each, clamps and two stainless steel nozzles mounted on independently adjustable armlets.

GYNMA-DPFHT7	Ø A	Ø B	Ø C	Hose lenght
GYNMA-DPFHT7	8"	6"	6"	2 x 4' - 1300°F

# GRNP-M



Rubber nozzle on stand with height adjustable rod. The models for hose diam 3" and 4" are specially developed for motorcycle applications. the stand can be removed from the floor platform in order to be fixed on the motorcycle lifting platform.

GRNP	Ø	Nozzle	Magnets
GRNP-75M	3"	GRN-16075/SV	✓
GRNP-100M	4"	GRN-160100	✓
GRNP-125	5"	GRN-160125	x
GRNP-150	6"	GRTN-150	x

# GMNT-HT



Trolley mounted nozzle with two locking wheels, stainless steel suction intake for high temperature (dimensions approved by TÜV-GERMANY) mounted on height adjustable rod.

GMNT-HT	Ø Hose	Nozzle	castor wheels	QUICK COUPLING
GMNT-75HT	3"	S.STEEL	4 (2 with brakes)	x
GMNT-100HT	4"	S.STEEL	4 (2 with brakes)	✓
GMNT-125HT	5"	S.STEEL	4 (2 with brakes)	x
GMNT-150HT	6"	S.STEEL	4 (2 with brakes)	✓

# GMNT-AU



Trolley mounted nozzle with two locking wheels , stainless steel suction intake for high temperature mounted on 20" tilting rod.

GMNT-AU	Ø
GMNT-AU100	4"
GMNT-AU150	6"

# GMNT-400200



Trolley mounted nozzle with two locking wheels, galvanized steel suction intake with big dimensions and adjustable in height.

GMNT	dim. (inches)	Ø
GMNT-400200	16"x 16"	8"

# GMNT-150MAN



Trolley mounted nozzle with two locking wheels, galvanized steel suction intake (big sized) with quick coupling and mounted on 20" tilting rod.

GMNT-MAN	dim. intake	Ø
GMNT-150MAN	14,17"x 11,81"	6"

# GMNT-E6K7B



Trolley mounted nozzle with two locking wheels, galvanized steel suction intake suitable for MERCEDES ACTROS euro 6 with specific exhaust type E6K7B.

GMNT-E6K7B	Ø
GMNT-E6K7B	6"



# GMNT-GTL



GMNT-GTL	Ø	HOSE CONNECTION DIAM.
GMNT-GTL	6.3"	6"

Trolley mounted nozzle with two locking wheels and TOUCHLESS end nozzle mounted on extendable arm and tight closing valve. This nozzle has been studied to reach (even with inspection pit) the centrally mounted exhaust pipes on trucks with the exhaust tip pointed down.





# GRTN

The GRTN (Gas Rubber Truck Nozzle) rubber nozzle has a 7" wide suction intake and a robust design to perfectly fit the heavy duty truck application.

The product has been optimized to accommodate the fully tight closing valve inside the nozzle body, together with the protection net; in this way, the product remains compact and flexible so that it can also be connected to mufflers difficult to reach.

The GRTN nozzle is configured with various types of grippers to fit every need of exhaust pipe fastening.





A brand of RO & Co S.p.A.  
(U.S. BRANCH)  
601 Brickell Key Drive  
Miami, Florida 33131, USA  
Tel. +1 305 (705) 5017  
sales@worky-america.com

www.worky-italy.com

## GRTN-MG - technical datasheet

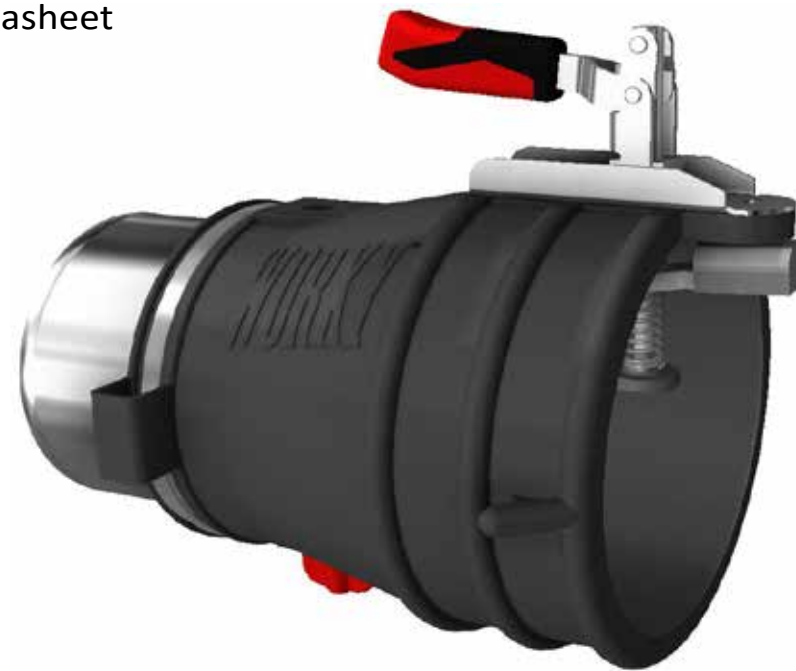
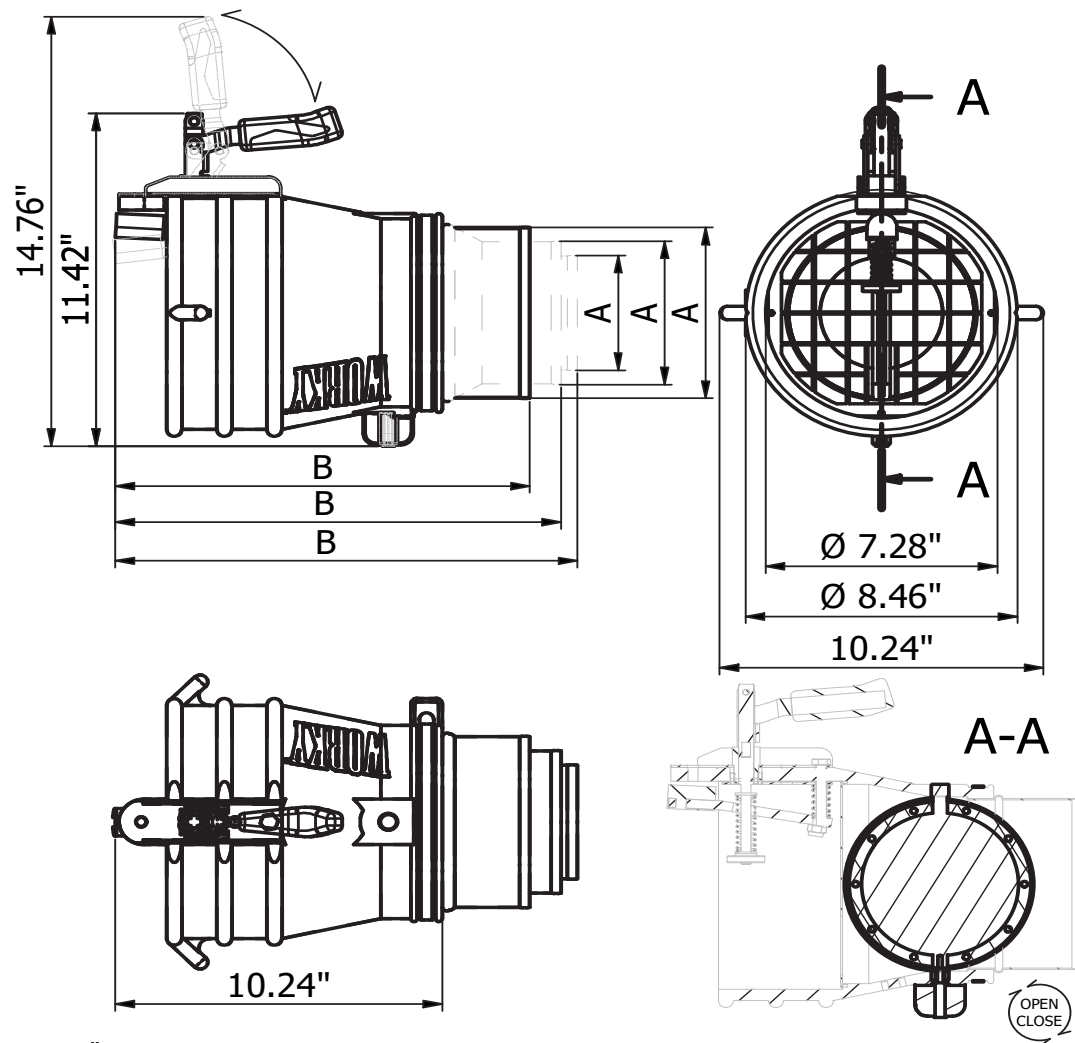

GR TN-MG	A Ø	B
GR TN-100MG	4"	14.53"
GR TN-125MG	5"	13.98"
GR TN-150MG	6"	13"



" x x H  
lb 6.61

THIS DRAWING IS PROPERTY OF RO & Co S.p.A. THE COMPLETE OR PARTIAL REPRODUCTION OF THIS DOCUMENT IS FORBIDDEN. THE OWNER RESERVES THE RIGHT TO UPDATE, MODIFY OR AMEND ANY SPECIFICATION WITHOUT PRIOR NOTICE.

Rev.00

11/06/2021

# GRTN



Heavy duty rubber nozzle with fully tight closing valve included in the body of the product, protection net and suction intake diam 7".

GRTN	Ø OF HOSE CONNECTION
GRTN-75	3"
GRTN-100	4"
GRTN-125	5"
GRTN-150	6"

# GRTN-K



Heavy duty rubber nozzle with fully tight closing valve included in the body of the product, protection net, clip for fixing to the exhaust pipe and suction intake diam 7".

GRTN-K	Ø OF HOSE CONNECTION
GRTN-100K	4"
GRTN-125K	5"
GRTN-150K	6"

# GRTN-MG



Heavy duty rubber nozzle with fully tight closing valve included in the body of the product, protection net, vulcanized clamp for fixing to the exhaust pipe and suction intake diam 7".

GRTN-MG	Ø OF HOSE CONNECTION
GRTN-100MG	4"
GRTN-125MG	5"
GRTN-150MG	6"

# GRTN-EG



Heavy duty rubber nozzle with internal expanding clamp and suction intake diam 7".

GRTN-EG	Ø OF HOSE CONNECTION
GRTN-100EG	4"
GRTN-125EG	5"
GRTN-150EG	6"

# GRTN-M



Heavy duty rubber nozzle with fully tight closing valve included in the body of the product, protection net, magnets for fixing to the exhaust pipe and suction intake diam 7".

GRTN-M	Ø OF HOSE CONNECTION
GRTN-100M	4"
GRTN-125M	5"
GRTN-150M	6"

# GMN-E6K7I



Special flexible nozzle diam 8" for exhaust extraction from trucks with underbody central exhaust pipe.

GMN	Ø GT2	Ø conn.
GMN-E6K7I	8"	6"





## GMNG



Steel nozzle diam 8" with manual gripper.

GMNG	Ø
GMNG-125	5"
GMNG-150	6"
GMNG-200	8"
GMNG-250200	8" (SUCTION OPENING 10")

## GMN



Galvanized metal nozzle with 0,80" intake for C.O. test and spring closing flap with handle.

GMN	Ø
GMN-75	3"
GMN-100	4"
GMN-125	5"
GMN-150	6"

# GMNC



Galvanized steel nozzle diam 6" with 90° bend, spring driven front closing flap with handle.

GMNC	Ø
GMNC-75	3"
GMNC-100	4"
GMNC-125	5"
GMNC-150	6"

# GMNCV



Galvanized steel nozzle diam 8" with 45° bend, handle and integrated closing valve.

GMNCV	Ø
GMNCV-150	6"
GMNCV-200	8"

# GMNVE



Galvanized sheet steel nozzle suitable to extract from vertical stacks and equipped with internal pin for matching the exhaust pipe and 2 handles for easier positioning.

GMNVE	Ø	L.
GMNVE-125	5"	8'
GMNVE-150	6"	8'





# GT2 400°F



The GT2 flexible hose has a structure made of armoured tissue vulcanised inside out with high temperature EPDM rubber achieving an operating temperature range of -40°F to + 400°F. The hose is totally crushproof thanks to the nylon helix which is keeping the structure opened also during stressing tests. The internal smooth and lubricated surface let the gas easily flow and block the acid aggression of the toxic gases preserving the long life of the product.

GT2	Ø	L.
GT2-752	3"	8'
GT2-755	3"	16'
GT2-757	3"	25'
GT2-7510	3"	33'
GT2-7512	3"	41'
GT2-7515	3"	49'
GT2-7520	3"	66'
GT2-7540	3"	131'

GT2	Ø	L.
GT2-1002	4"	8'
GT2-1005	4"	16'
GT2-1007	4"	25'
GT2-10010	4"	33'
GT2-10012	4"	41'
GT2-10015	4"	49'
GT2-10020	4"	66'
GT2-10040	4"	131'

GT2	Ø	L.
GT2-1252	5"	8'
GT2-1255	5"	16'
GT2-1257	5"	25'
GT2-12510	5"	33'
GT2-12512	5"	41'
GT2-12515	5"	49'
GT2-12520	5"	66'

GT2	Ø	L.
GT2-1502	6"	8'
GT2-1505	6"	16'
GT2-1507	6"	25'
GT2-15010	6"	33'
GT2-150120	6"	41'
GT2-150152	6"	49'
GT2-15020	6"	66'

GT2	Ø	L.
GT2-2005	8"	16'
GT2-20010	8"	33'
GT2-20015	8"	66'



Flexible hose made of one aluminized coated fiberglass fabric sewn with one silicone coated both sides by glass fabric, external metal wire sewn with yellow high temperature resistant scuffstrip onto the wall. Each end is reinforced with helix-free cuffs and the hoses should not be cut in order to maintain the fire-proof performances.

GT3  600°F

GT3	Ø	L.
GT3-1002	4"	8'
GT3-1005	4"	16'
GT3-1007	4"	25'
GT3-10010	4"	33'
GT3-1252	5"	8'
GT3-1255	5"	16'
GT3-1257	5"	25'
GT3-12510	5"	33'
GT3-1502	6"	8'
GT3-1505	6"	16'
GT3-1507	6"	25'
GT3-15010	6"	33'
GT3-2002	8"	8'
GT3-2005	8"	16'
GT3-2007	8"	25'
GT3-20010	8"	33'

GT5  950°F

GT5	Ø	L.
GT5-1002	4"	8'
GT5-1005	4"	16'
GT5-1007	4"	25'
GT5-10010	4"	33'
GT5-1252	5"	8'
GT5-1255	5"	16'
GT5-1257	5"	25'
GT5-12510	5"	33'
GT5-1502	6"	8'
GT5-1505	6"	16'
GT5-1507	6"	25'
GT5-15010	6"	33'
GT5-2002	8"	8'
GT5-2005	8"	16'
GT5-2007	8"	25'
GT5-20010	8"	33'

GT7  1300°F

GT7	Ø	L.
GT7-1002	4"	8'
GT7-1005	4"	16'
GT7-1007	4"	25'
GT7-10010	4"	33'
GT7-1252	5"	8'
GT7-1255	5"	16'
GT7-1257	5"	25'
GT7-12510	5"	33'
GT7-1502	6"	8'
GT7-1505	6"	16'
GT7-1507	6"	25'
GT7-15010	6"	33'
GT7-2002	8"	8'
GT7-2005	8"	16'
GT7-2007	8"	25'
GT7-20010	8"	33'

GT1  1850°F

GT1	Ø	L.
GT1-1002	4"	8'
GT1-1005	4"	16'
GT1-1007	4"	25'
GT1-10010	4"	33'
GT1-1252	5"	8'
GT1-1255	5"	16'
GT1-1257	5"	25'
GT1-12510	5"	33'
GT1-1502	6"	8'
GT1-1505	6"	16'
GT1-1507	6"	25'
GT1-15010	6"	33'
GT1-2002	8"	8'
GT1-2005	8"	16'
GT1-2007	8"	25'
GT1-20010	8"	33'





# GTA



Rugged aluminum hose resistant up to 600° F and extensible from 3' to 10' of total length. Suitable for connecting the hose reels to rigid piping.

GTA	Ø
GTA-100	4"
GTA-120	4.7"
GTA-130	5.1"
GTA-150	6"

GTA	Ø
GTA-160	6.3"
GTA-180	7"
GTA-200	8"
GTA-250	10'

# GTP



Flexible hose up to 230°F made of PVC-coated polyamide fabric on both sides and built-in spiral wire of harmonic steel.

GTP	Ø	L.
GTP-100	4"	33'
GTP-125	5"	33'
GTP-130	5.1"	33'
GTP-150	6"	33'

GTP	Ø	L.
GTP-160	6.3"	33'
GTP-200	8"	33'
GTP-250	10"	33'
GTP-300	12"	33'

# GCC



Metal cowling for flexible hose connection.

GCC	Ø
GCC-75	3"
GCC-100	4"
GCC-125	5"
GCC-150	6"
GCC-200	8"

# GWB



Wall storage bracket for flexible hoses and Y pieces with nozzles.

GWB	Ø of suitable hoses
GWB-100	3" - 4"
GWB-125	5" - 6"

# GF



Metallic hose clamp suitable to fix flexible hoses on cowlings or nozzles.

GF	Ø
GF-75	3"
GF-100	4"
GF-125	5"
GF-130	5.1"
GF-150	6"

GF	Ø
GF-160	6.3"
GF-200	8"
GF-250	10"
GF-315	12"

# GSR



Bayonet quick connection coupling for flexible hoses. The code comprehends both the male and the female part

GSR	Ø
GSR-75	3"
GSR-100	4"
GSR-125	5"
GSR-150	6"
GSR-200	8"

# GY



Symmetrical Y piece with 2 hoses GT2 4' long each, female quick coupling and hose clamps.

GY	ØA	ØB	ØC
GY-757575	3"	3"	3"
GY-1007575	4"	3"	3"
GY-100100100	4"	4"	4"
GY-125100100	5"	4"	4"
GY-150100100	6"	4"	4"
GY-150125125	6"	5"	5"

# GYG



Symmetrical Y piece suitable for a quick connection to the GRNG nozzle, two hoses GT2 4' long each and hose clamps.

GYG	Ø	Lenght
GYG-1007575	3"	2 x 4'
GYG-100100100	4"	2 x 4'

# GYOG



Symmetrical Y piece suitable for a quick connection to the GON oval nozzle, two hoses GT2 4' long each and hose clamps.

GYOG	Ø A	Ø B	Lenght
GYOG-7575	3"	3"	2 x 4'
GYOG-100100	4"	4"	2 x 4'

# GDY



Symmetrical Y piece with anti-slip edging for flexible hoses and female part of quick coupling integrated.

GDY	Ø A	Ø B	Ø C
GDY-757575	3"	3"	3"
GDY-1007575	4"	4"	4"
GDY-100100100	4"	4"	4"
GDY-1257575	5"	3"	3"

GDY	Ø A	Ø B	Ø C
GDY-125100100	5"	4"	4"
GDY-125125125	5"	5"	5"
GDY-150125125	6"	5"	5"
GDY-150150150	6"	6"	6"

# GDYG



Symmetrical Y piece suitable for a quick connection to the GRNG nozzle.

GDYG	Ø A	Ø B	Ø C
GDYG-1007575	4"	3"	3"
GDYG-100100100	4"	4"	4"

# GDYOG



Symmetrical Y piece suitable for a quick connection to the GON nozzle.

GDYOG	Ø A	Ø B
GDYOG-7575	3"	3"
GDYOG-100100	4"	4"