

GRTN

The GRTN (Gas Rubber Truck Nozzle) rubber nozzle has a 7" wide suction intake and a robust design to perfectly fit the heavy duty truck application.

The product has been optimized to accommodate the fully tight closing valve inside the nozzle body, together with the protection net; in this way, the product remains compact and flexible so that it can also be connected to mufflers difficult to reach.

The GRTN nozzle is configured with various types of grippers to fit every need of exhaust pipe fastening.



A brand of RO & Co S.p.A.
(U.S. BRANCH)
601 Brickell Key Drive
Miami, Florida 33131, USA
Tel. +1 305 (705) 5017
sales@worky-america.com

www.worky-italy.com

GRTN-MG - technical datasheet

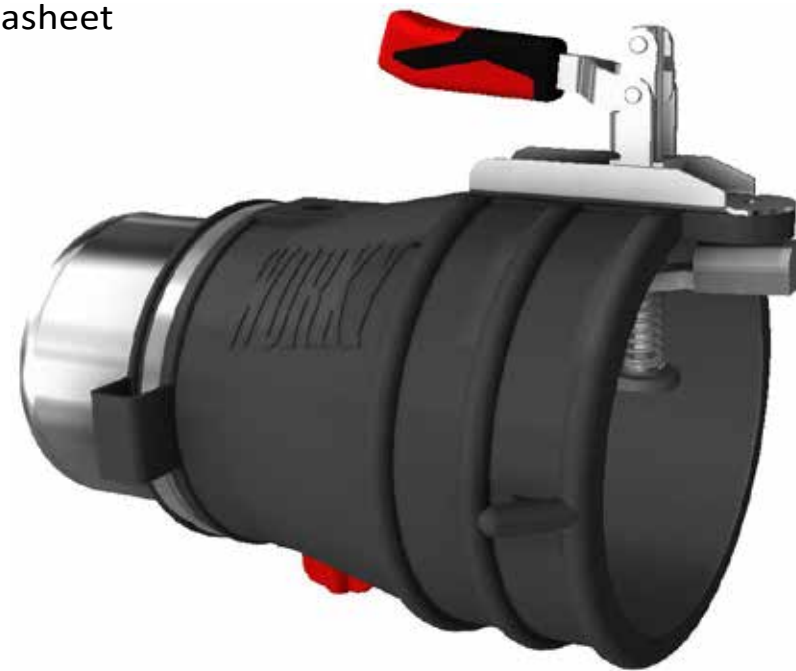
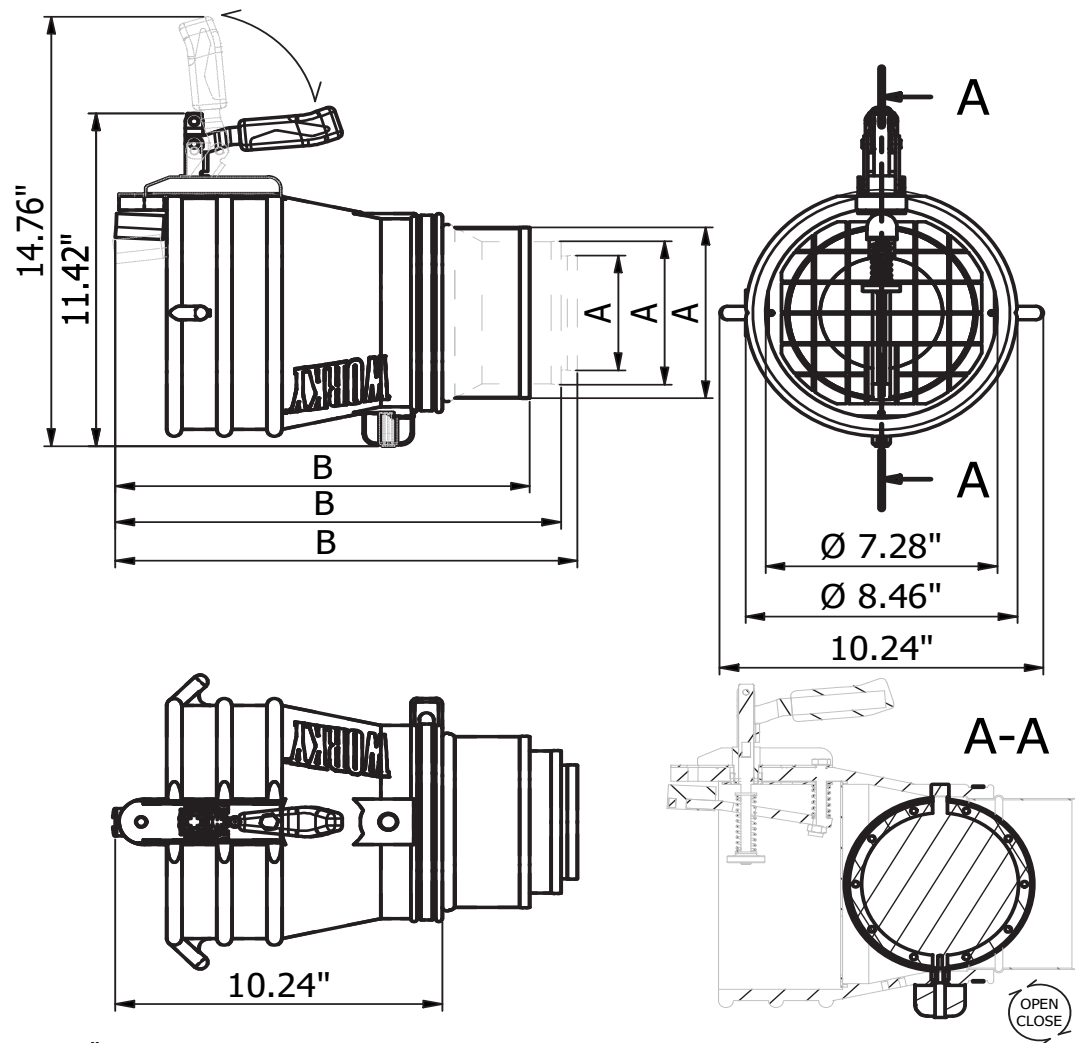

GR TN-MG	A Ø	B
GR TN-100MG	4"	14.53"
GR TN-125MG	5"	13.98"
GR TN-150MG	6"	13"



" x x H
lb 6.61

THIS DRAWING IS PROPERTY OF RO & Co S.p.A. THE COMPLETE OR PARTIAL REPRODUCTION OF THIS DOCUMENT IS FORBIDDEN. THE OWNER RESERVES THE RIGHT TO UPDATE, MODIFY OR AMEND ANY SPECIFICATION WITHOUT PRIOR NOTICE.

Rev.00

11/06/2021

GRTN



Heavy duty rubber nozzle with fully tight closing valve included in the body of the product, protection net and suction intake diam 7".

GRTN	Ø OF HOSE CONNECTION
GRTN-75	3"
GRTN-100	4"
GRTN-125	5"
GRTN-150	6"

GRTN-K



Heavy duty rubber nozzle with fully tight closing valve included in the body of the product, protection net, clip for fixing to the exhaust pipe and suction intake diam 7".

GRTN-K	Ø OF HOSE CONNECTION
GRTN-100K	4"
GRTN-125K	5"
GRTN-150K	6"

GRTN-MG



Heavy duty rubber nozzle with fully tight closing valve included in the body of the product, protection net, vulcanized clamp for fixing to the exhaust pipe and suction intake diam 7".

GRTN-MG	Ø OF HOSE CONNECTION
GRTN-100MG	4"
GRTN-125MG	5"
GRTN-150MG	6"

GRTN-EG



Heavy duty rubber nozzle with internal expanding clamp and suction intake diam 7".

GRTN-EG	Ø OF HOSE CONNECTION
GRTN-100EG	4"
GRTN-125EG	5"
GRTN-150EG	6"

GRTN-M



Heavy duty rubber nozzle with fully tight closing valve included in the body of the product, protection net, magnets for fixing to the exhaust pipe and suction intake diam 7".

GRTN-M	Ø OF HOSE CONNECTION
GRTN-100M	4"
GRTN-125M	5"
GRTN-150M	6"

GMN-E6K7I



Special flexible nozzle diam 8" for exhaust extraction from trucks with underbody central exhaust pipe.

GMN	Ø GT2	Ø conn.
GMN-E6K7I	8"	6"



GMNG



Steel nozzle diam 8" with manual gripper.

GMNG	Ø
GMNG-125	5"
GMNG-150	6"
GMNG-200	8"
GMNG-250200	8" (SUCTION OPENING 10")

GMN



Galvanized metal nozzle with 0,80" intake for C.O. test and spring closing flap with handle.

GMN	Ø
GMN-75	3"
GMN-100	4"
GMN-125	5"
GMN-150	6"

GMNC



Galvanized steel nozzle diam 6" with 90° bend, spring driven front closing flap with handle.

GMNC	Ø
GMNC-75	3"
GMNC-100	4"
GMNC-125	5"
GMNC-150	6"

GMNCV



Galvanized steel nozzle diam 8" with 45° bend, handle and integrated closing valve.

GMNCV	Ø
GMNCV-150	6"
GMNCV-200	8"

GMNVE



Galvanized sheet steel nozzle suitable to extract from vertical stacks and equipped with internal pin for matching the exhaust pipe and 2 handles for easier positioning.

GMNVE	Ø	L.
GMNVE-125	5"	8'
GMNVE-150	6"	8'